

See overleaf for additional notes on; fitting blinds to timber frames

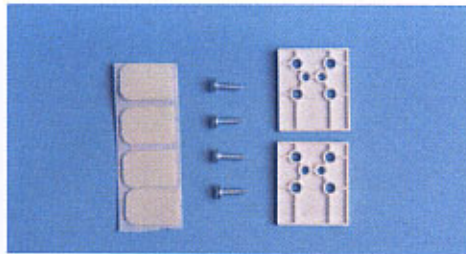

1. Fitting tools required include star point screwdriver, scissors, drill & Ø2.5mm drill bit



2. Accessories pack (packing pieces as required)

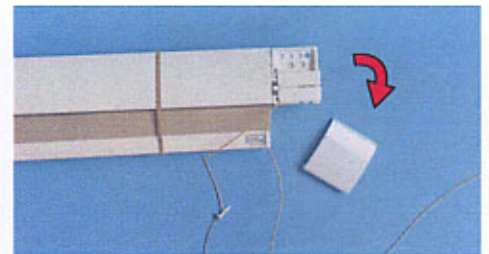

3. Unclip trimcap on both sides



4. Using blind, mark positions for the cord grommet holes



5. With the drill at 90° to the surface, drill Ø2.5mm hole 1 off on each side

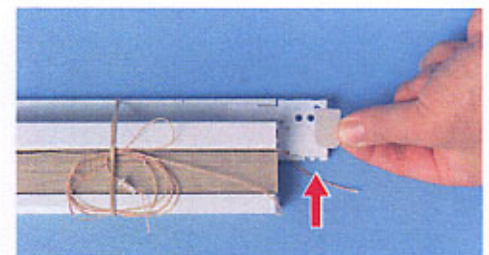

6. Attach double sided adhesive pad

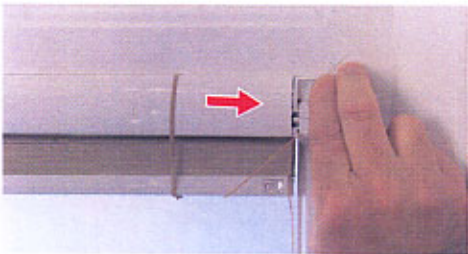

7. Stick blind onto frame leaving rubber band around blind

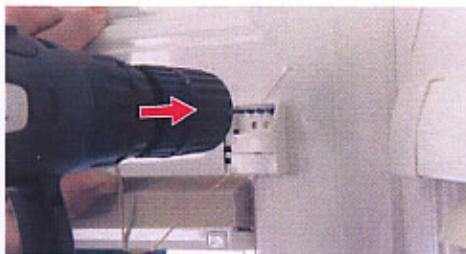

8. Drill Ø2.5mm holes 2 off on each side

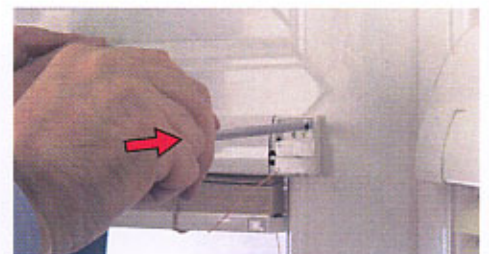

9. Hand screw fixings



10. Push cord knot into hole, push fixing grommet into hole, aligning groove to cord

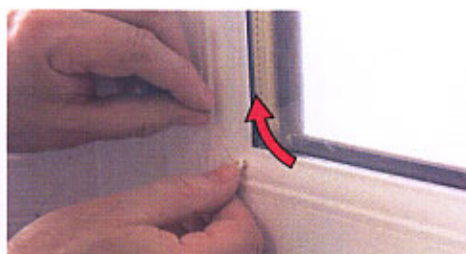

11. Holding button, pull cord tight to secure

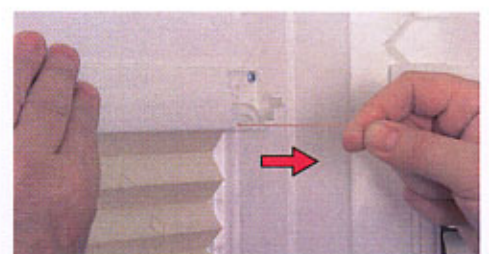

12. Remove rubber band. Carefully release locking gate. Pull cord to tension approx. equal on both sides

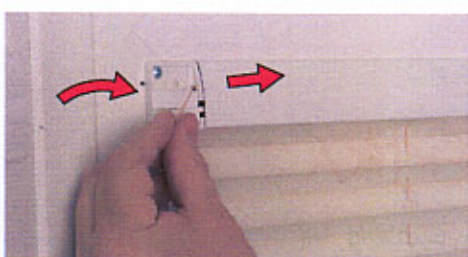

13. Press locking gate closed to secure cord. Cut-off excess cord leaving 100mm min. Tuck through hole in endcap

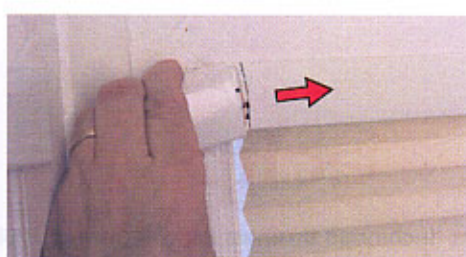

14. Clip on trimcaps.



15. If optional handle is required to be fitted, attach handle using pre-drilled holes and screws provided.



Fitting Blind to Timber Frames



a1. Fitting tools required include Ø4mm drill bit and star point screwdriver



a2. Mark position as outlined in step 8 (over leaf). Drill Ø4mm hole to depth of 10mm



a3. Screw in brass inserts until flush with timber surface



a4. Push cord knot into brass insert, push grommet into brass insert, aligning groove to cord



Continue as for PVC frames from step 11 (over leaf)

